



22 Henry Road Morisset Park NSW

4 3 7

Set on a quiet road overlooking the scenic shores of Lake Macquarie, this modern single level waterfront home on a near half-acre block offers an outstanding lifestyle opportunity for the lucky buyer.

Boasting outstanding views over Lake Macquarie, this 2017-built Beechwood home offers optimum energy efficiency and sustainable living features, the security of a spacious brick and tile build with all the modern comforts that you deserve.

Proudly sitting in an elevated waterfront position adjacent to the popular Trinity Point Estate and only a short walk to the exclusive '8@Trinity' restaurant and world-class marina, this home will be highly sought-after.

Features include, but not limited to:

Price : \$ 2,050,000
Land Size : 1927 sqm
View : <https://www.ellejayne.com.au/sale/nsw/lake-macquarie-west/morisset-park/residential/home/8104298>



Sally Wrigley
(02) 4973 2775



Ben Wrigley
1300 322 366

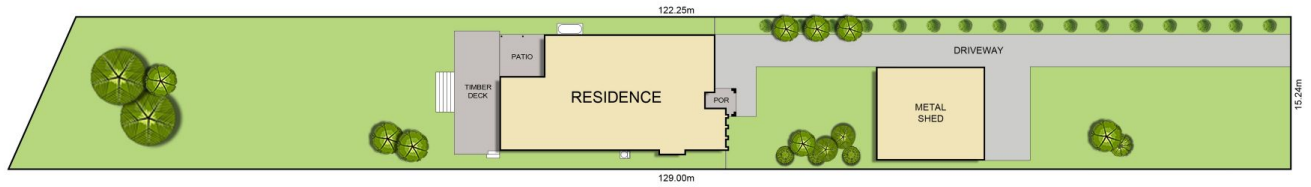

SITE PLAN



FLOOR PLAN

This floor plan including furniture, fixture measurements and dimensions are approximate and for illustrative purposes only.
BoxBrownie.com gives no guarantee, warranty or representation as to the accuracy and layout.
All enquiries must be directed to the agent, vendor or party representing this floor plan.

22 Henry Drive, Morisset Park